

INSTRUCTIONS

8' x 8' Backdrop Banner



Includes:

Winged Bolt (x4)

Screw (x2)

Foot (x2)

Horizontal Telescoping Poles (x2) [longer poles]

Vertical Telescoping Poles (x2) [shorter poles]

*****You will need a Phillips Screwdriver to assemble. Not included.**



1

Position the first foot next to the vertical telescoping pole. Insert the pole into the hole located on the top of the foot. Thread a screw through the hole in the bottom center of the foot and tighten with a Phillips screwdriver.

Repeat step 1 for second foot.

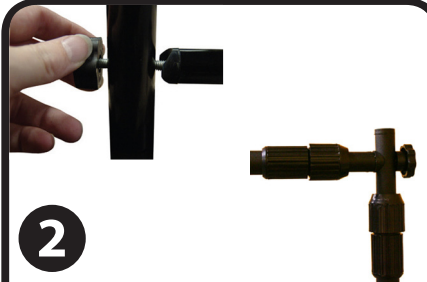

2

Align the contoured curve of one of the horizontal poles to the hole at the end of one of the upper vertical telescoping pole holes. Insert a winged bolt through the hole in the vertical telescoping pole and screw into the threaded hole in the horizontal pole. Turn the winged bolt clockwise until tight. *****Do NOT over-tighten winged bolts or UNIT WILL FAIL.**



3

Before attaching other side of horizontal pole to the vertical pole, thread pole sleeve around horizontal pole. Then attach top horizontal pole to vertical pole like previous. If contour is not aligned with pole, turn telescoping joint clockwise to loosen and align.



4

Align the contoured curve of the other horizontal pole to the hole at the end of one of the lower vertical telescoping poles. Follow directions on step 2. Repeat threading pole sleeve of flag around pole before attaching the other side.

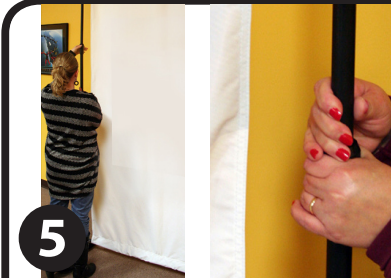

5

To make banner taut simply lift the upper horizontal telescoping pole and turn the telescoping joint of the vertical telescoping poles counterclockwise and lock in place by turning the telescoping joint clockwise when banner is taut. Repeat with crossbar to adjust width of frame.



INSTRUCTIONS

X-Banner



Includes:
Body Piece
Arms (x2)

1



Place the X-Banner body piece upright by extending the feet outward. Adjust the height of the telescoping pole on the X-Banner body piece by flipping the switch to the center position. *Having the switch turned to the left or right position will lock the height of the telescoping pole.*

2



Take the two arms with hooks and attach them to the center piece at the top of the telescoping pole on the X-Banner body piece.

3



Using your banner with grommets, attach each of the four corners to the X-Banner hooks, starting with the top first.

4



In order to properly display your banner on the X-Banner body piece, raise the telescoping pole until taut.



INSTRUCTIONS

PTH Hardware - 6'-15' Portable Half Drop and Teardrop



Includes:

Sectional Aluminum and Fiberglass Pole
Ground Spike
Carrying Case

The number, length and style of sectional pole pieces will vary based on banner size and shape.

1

Assemble sectional poles by placing end to end - largest to smallest.

Note: If any sectional poles slide down several inches, then they are upside down.

2

Slide the banner onto the pole via the pole sleeve, starting from the small end.

Note: Be sure to feed the hardware all the way through the sleeve, to the tip of the banner.

3

Loosen the screw of the attachment hook near the base of the pole and slide it towards the loop at the bottom of your banner. Then put that loop into the attachment hook and adjust the hook position to make banner flat (taut). Tighten the screw of the attachment hook to secure the banner. ***For 15' hardware, there may be an attachment hook OR a tether line.***

4

Hammer taller portion of the ground spike fully into the ground. Then insert pole with banner onto peg. For best vertical presentation, check with a level front-to-back and side-to-side.



WARNING:
Do not hammer the shorter peg with the rubber O-rings.



This product is for outdoor promotional use only and should not be left out in extreme weather conditions. Please use common sense guidelines and do not display this product outdoors when extreme winds or storms may be present.

INSTRUCTIONS

Standard Cross Base

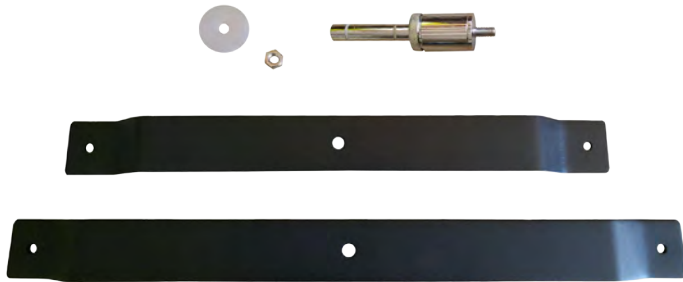

Includes:
20" Bar
23" Bar
Post
Nut
Spacer*

1

Place 20" bar on a surface with feet facing downwards. Place spacer on top, aligning spacer hole with center hole of the bar.

2

Place 23" bar on top, sandwiching the spacer between both bars. Align holes.

3

With the 20" bar on bottom, 23" bar on top, and spacer in between, marry the two bars together with the post.

4

Screw the nut onto the bottom of the post to hold the pieces together.

5

To use, separate both legs until perpendicular.

6

Slide assembled sectional pole with banner (see reverse side for instructions) onto the post of the cross base.

* Spacer may not be included with cross base. It is an optional piece and not required for use.