

INSTRUCTIONS

Collaboration Station



Includes:
Adjustable Tablet Holder
90° Base Angle Joints (x2)
U Joints (x2)
Poles (x4)
Cross Bar
Carrying Bag & Graphic



1

Using the numbers on the frame, connect the straight tubes. Be sure the snap button pops through the hole to lock the joint. Place Cross Bar ends into the holes of both assembled poles. Connect U Joints and 90° Base Angle Joints by matching the numbers on the frame.



2

Place the Frame upright. From the top, slide the Graphic down over the Frame and zip the Graphic closed.

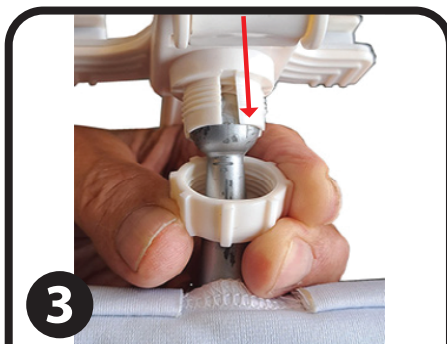

3

Attach the Tablet Holder by removing the threaded collar, then slip it down over the ball on the post. Snap connector sleeve onto the ball.

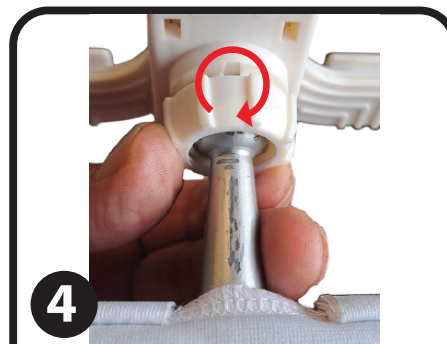

4

Thread the collar back up the connector sleeve, enclosing the ball into the Holder bracket.

